



**SIX PARCELS/ 20.89+/- ACRES
 RANDOLPH COUNTY, NC
 FOR SALE - \$2,900,000**

US HWY 311 / GLENOLA INDUSTRIAL DRIVE

GREAT INVESTMENT POTENTIAL—PRICE BASED ON 10% GROSS RETURN

4 INDUSTRIAL TENANTS - BUILDINGS FULLY LEASED FOR YEARS



Parcel Number	Address	Deed Book/Page	Acreage
7737124119	5270 Glenola Ind. Dr.	001243/01788	2.10 acres
7737114965	S.E. of 5270 Glenola Ind. Dr.	001477/0913	.51 acres
7737121601	5261 & 5275 Glenola Ind. Dr.	001313/01775	5.11 acres
7737028142	5250 & 5252 Glenola Ind. Dr.	001125/00818	8.50 acres
7737019804	S. of 5252 Glenola Ind. Dr.	001440/00370	2.0 acres
7737021127	S.W. of 5250 Glenola Ind. Dr.	001442/00197	2.67 acres



P.O. Box 1885, Jamestown, NC 27282

(O) 336.454.5427 (E-fax) 336.217.8372

Vicinity Maps

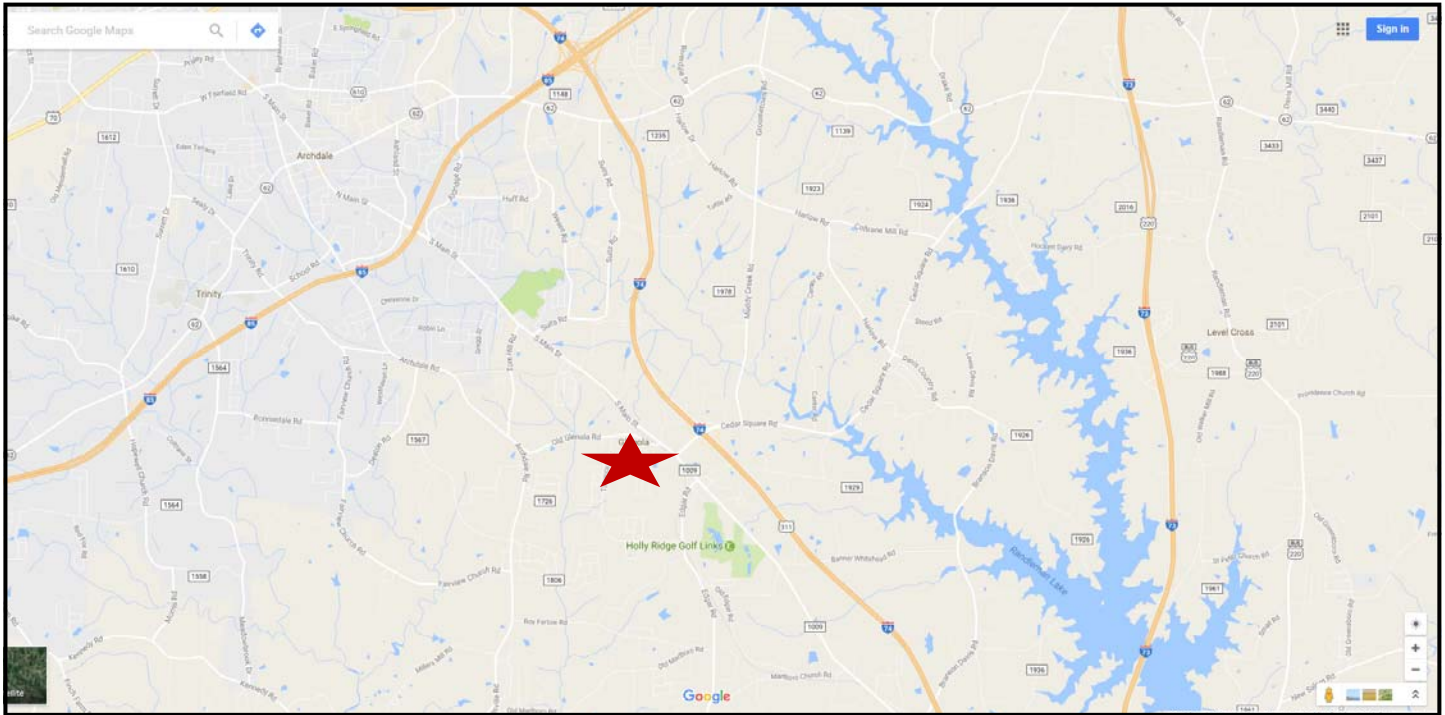

**Easy Access to Interstates 74, 85 and 73
Near Greensboro, High Point, Archdale, Winston-Salem**

